

FILED
GREENVILLE CO. S. C.
JUN 12 12 28 PM 1968
OLLIE FARMWORTH
R. M. G.

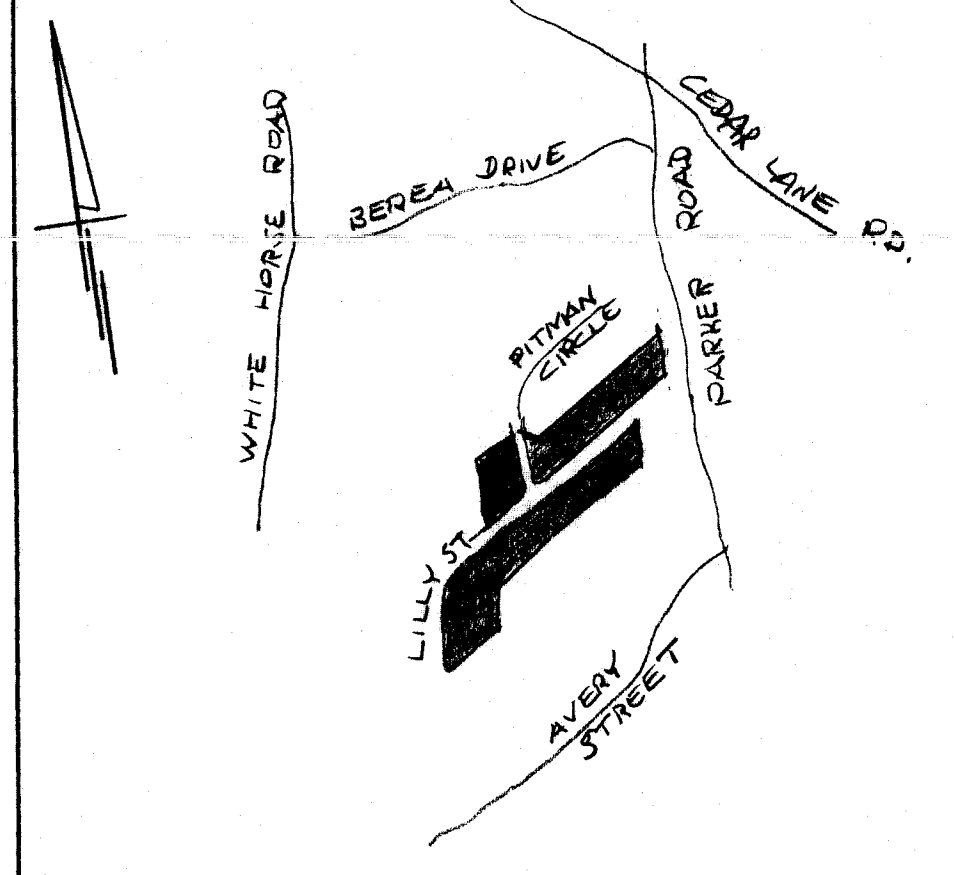

CERTIFICATE OF OWNERSHIP AND DEDICATION

"The undersigned hereby acknowledge that I am (we are) the owner(s) of the property shown and described hereon and that I (we) hereby adopt this plan of subdivision with my (our) free consent and that I (we) establish the minimum building restriction lines, and hereby dedicate to public use as roads, streets, and easements, forever all areas so shown or indicated on said plat.

JUN 12 1968 Signed C. A. Talley
Signed _____
Signed _____
Signed _____

CERTIFICATE OF ACCURACY

"I, _____, certify that this plat was (drawn by me) (drawn under my supervision) (an actual survey made under my supervision) from (an actual survey made by me) (deed description recorded in Book _____, Page _____, Book _____, Page _____, etc.) (other); that the error of closure as calculated by latitudes and departures is _____; that the boundaries not surveyed are shown as broken lines plotted from information found in Book _____, Page _____; that this plat was prepared in accordance with the Greenville County Subdivision Regulations as adopted.

JUN 11 1968 Signed R. B. Bruce
Date Licensed Engineer or Registered Surveyor
S. C. Registration No. _____ 1052

SUMMARY APPROVAL

This plat meets the minimum requirements of the Greenville County Subdivision Regulations. Approval for recording is hereby granted.

JUN 12 1968 Signed Walter G. Winterbottom
Date Director, Greenville County Planning Commission

Filed This 12 day of June, 1968
And Recorded in Vol. WWW Page 20 add 26
Ollie Farmworth
Register Name Conveyance Greenville County, S. C.

**FINAL PLAT
HUNTLY ACRES**

*William Builders Inc. By Frank Williams
Tally Huntly Acres by C. A. Talley*

OWNERS _____ SURVEYOR _____

NO. OF ACRES _____ MILES OF NEW ROAD _____
10.7 _____ 0-

NO. OF LOTS _____ DATE _____
36 _____ 3 JUNE 1968
ERROR OF CLOSURE 1/32.00

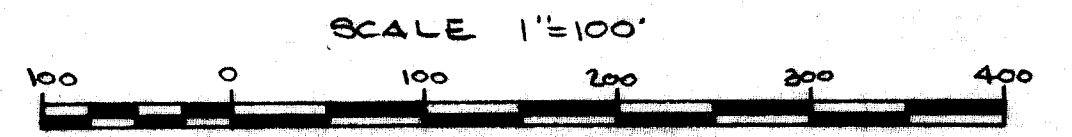

A VARIANCE WAS GRANTED BY THE GREENVILLE COUNTY PLANNING COMMISSION ON APRIL 25, 1968, FOR THE PURPOSE OF REDUCING THE BUILDING SETBACK REQUIREMENT FOR LOTS 1-16 FROM 30 FEET TO 20 FEET.

500 WWW-20

